

Bottom Chord	Max. Sprinkler Pipe Diameter, in. (mm)
28TSC2.75, 28TSC3.00 or 28TSC4.00	2 (51)
33TSC2.75, 33TSC3.00 or 33TSC4.00	3 (76)
43TSC2.75, 43TSC3.00 or 43TSC4.00	2-1/2 (64)
54TSC3.00 or 54TSC4.00	3-1/2 (89)
68TSC4.00 or 97TSC4.00	4 (102)

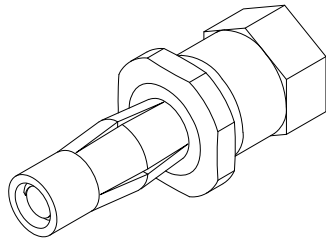
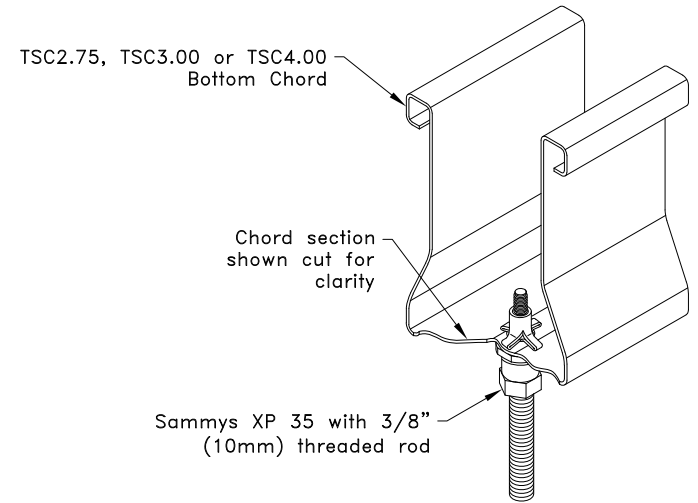
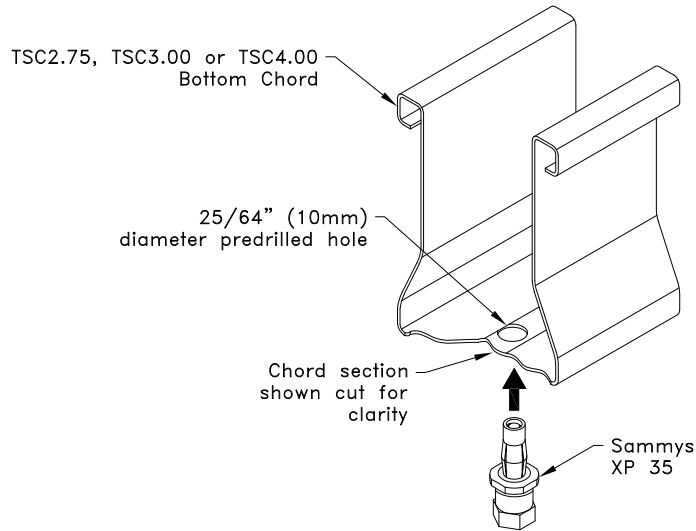

Sammys X-Press 35
(XP 35)

General Notes:

1. Truss must be properly loaded for sprinkler pipe load. Refer to TrusSteel Technical Bulletin TB00.09.01, "Sprinkler Pipes - Truss Loading & Connections".
2. It is the responsibility of the Building Designer to verify that the hanger design given in this detail conforms with the overall sprinkler system support design.
3. Refer to TB07.09.20, "Attachment of Mechanical Systems to TrusSteel Trusses" for acceptable location of hole.
4. Connections determined in accordance with UL 203 document titled "Standard For Pipe Hanger Equipment For Fire Protection Service", and assume Schedule 40 steel pipe.
5. Pipe hanger spacing shall not exceed 12 ft (3658mm) for pipes up to and including 1-1/4 in. (32mm) diameter and 15 ft (4572mm) for pipes greater than 1-1/4 in. (32mm) diameter per NFPA 13 2022 "Standard For The installation of Sprinkler Systems".



www.TrusSteel.com

155 Harlem Ave., North Building, 4th Floor / Glenview, IL 60025 / (800) 755-6001

Bottom Chord Sprinkler Pipe Hanger
for 4" (102mm) Max. Diameter Pipe
Using Sammys X-Press 35 (XP 35)

Alpine, a division of ITW Building Components Group, Inc. shall not be responsible for any performance failure in a connection due to a deviation from this detail. Any variation from this detail shall be approved in advance by Alpine, a division of ITW Building Components Group, Inc.

Standard Detail:
TS049L

Date:
06/01/22

TrusSteel Detail Category:
Sprinkler Pipe Hangers