

Wall Top Plate / Min Thickness	Allowable U lbs (kN) ^A			Allowable P1 lbs (kN) ^A							
	TS2.75	TSC3.00 or TSC4.00	Any Chord Size	28TSC		33TSC		43TSC		54, 68, 97TSC	
	Clip on One Face ^B	Clip on One Face ^B	Clip on Both Faces	Clip on One Face	Clip on Both Faces	Clip on One Face	Clip on Both Faces	Clip on One Face	Clip on Both Faces	Clip on One Face	Clip on Both Faces
20g (33 mils) Grade 33	350 (1.56)	350 (1.56)	840 (3.74)	880 (3.91)	1770 (7.87)	880 (3.91)	1770 (7.87)	880 (3.91)	1770 (7.87)	880 (3.91)	1770 (7.87)
20g (33 mils) Grade 50	400 (1.78)	510 (2.27)	1210 (5.38)	1030 (4.58)	2050 (9.12)	1280 (5.69)	2550 (11.34)	1280 (5.69)	2550 (11.34)	1280 (5.69)	2550 (11.34)
18g (43 mils) Grade 33		460 (2.05)	1090 (4.85)					1320 (5.87)	2630 (11.70)	1320 (5.87)	2630 (11.70)
18g (43 mils) Grade 50		660 (2.94)	1580 (7.03)					1900 (8.45)	3800 (16.90)	1900 (8.45)	3800 (16.90)
16g (54 mils) Grade 33		580 (2.58)	1370 (6.09)					1850 (8.23)	3700 (16.46)	1850 (8.23)	3700 (16.46)
16g (54 mils) Grade 50	400 (1.78) ^C	740 (3.29)	1980 (8.81)	1900 (8.45)	3800 (16.90)	2180 (9.70)	4360 (19.39)	1900 (8.45)	3800 (16.90)	2180 (9.70)	4360 (19.39)
14g (68 mils) Grade 33		730 (3.25)	1730 (7.70)								
14g (68 mils) Grade 50		740 (3.29) ^D	2050 (9.12) ^E								
12g (97 mils) Grade 33			2050 (9.12) ^E								
12g (97 mils) Grade 50		2050 (9.12) ^F									

- A. Allowable loads shown on this detail are not in combination.
 B. Uplift connections with clip on one face require a web above connection. For values in chart, TSC2.75 minimum web is 33W.75x.75 and TSC3.00 or TSC4.00 minimum web is 33W1.5x.75.
 C. If web above connection is 33W.75x1.5, U = 710 (3.16 kN)
 D. If web above connection is 33C1.5x1.5, U = 1010 (4.49 kN)
 E. For 33TSC and greater, U = 2460 lbs (10.94 kN).
 F. For 33TSC, U = 2550 lbs (11.34 kN). For 43TSC and greater, U = 3260 lbs (14.50 kN).

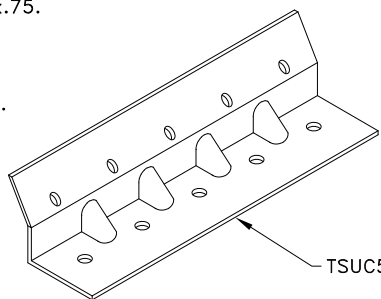

Allowable P2 lbs (kN) ^A		
Chord	Clip on One Face	Clip on Both Faces
28TSC	520 (2.31)	1050 (4.67)
33TSC	570 (2.54)	1210 (5.38)
≥ 43TSC	570 (2.54)	1470 (6.54)

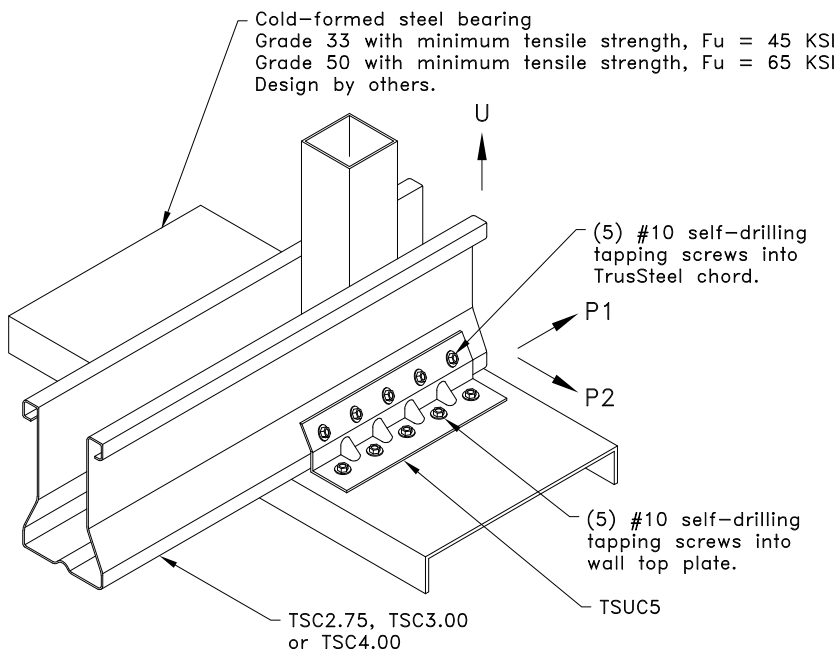

General Notes:

- The wall top plate is to be designed by the job engineer. The wall top plate and connection of top plate to wall stud must be designed to support the loads applied to it (downward, upward and lateral).
- If a clip is required on both faces, attach the second clip to the opposite face of the chord as detailed.
- Multi-ply trusses require a clip on each face. Refer to TrusSteel detail drawing TS023A for ply-to-ply connections for 3-Ply trusses with a clip on each face.
- Cold-Formed Steel calculations are per the 2020 supplement to AISI 2016 "North American Specification for the Design of Cold-Formed Steel Structural Members" (S100-16/S2-20).



www.TrusSteel.com

155 Harlem Ave., North Building, 4th Floor / Glenview, IL 60025 / (800) 755-6001

TSUC5 Uplift Attachment To Cold-Formed Steel Using #10SDS

Alpine, a division of ITW Building Components Group, Inc. shall not be responsible for any performance failure in a connection due to a deviation from this detail. Any variation from this detail shall be approved in advance by Alpine, a division of ITW Building Components Group, Inc.

Standard Detail:

TS029

Date:

06/01/22

TrusSteel Detail Category:

Truss-To-Bearing: Cold-Formed Steel