

TSJH22

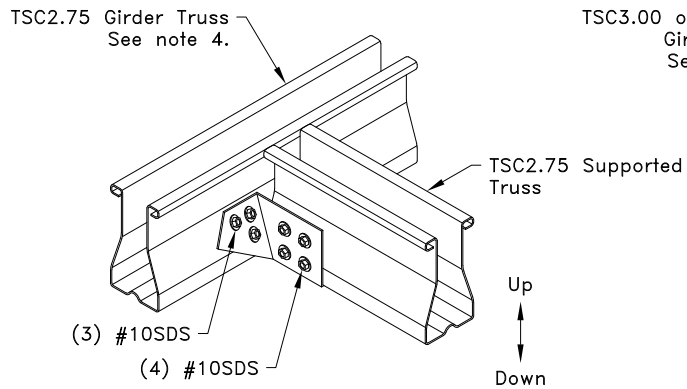

TSJH24

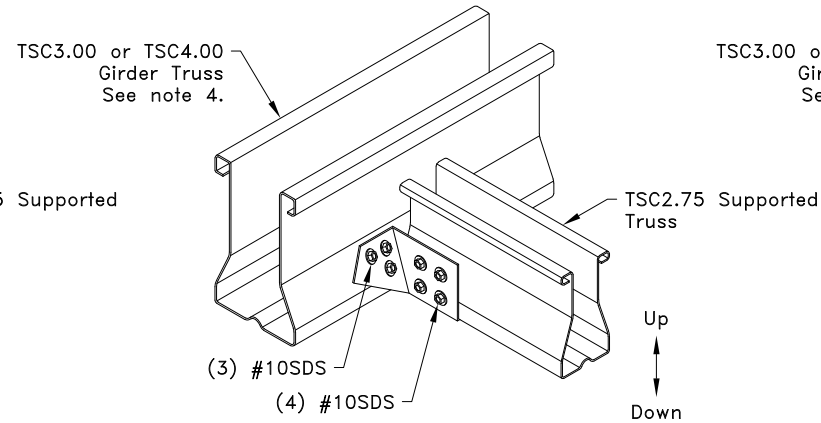

TSJH44

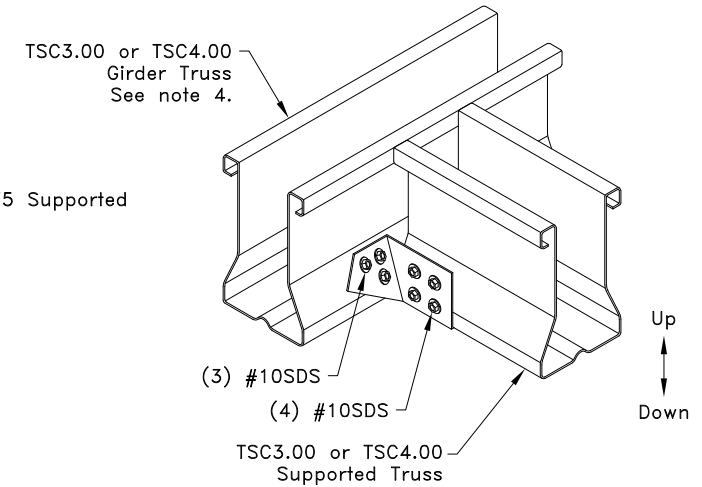

TSJH22 Allowable Loads Up and Down lbs (kN)

| Load Direction | Girder Truss | | |
|---------------------|---------------|---------------|---------------|
| | 28TSC 22ga | 33TSC 20ga | 43TSC 18ga |
| Down | 730 (3.25) | 910 (4.05) | 1360 (6.05) |
| Up - Gravity & Wind | 670 (2.98) | 760 (3.38) | 1000 (4.45) |

TSJH24 And TSJH44 Allowable Loads Up and Down lbs (kN)

| Load Direction | Girder Truss | | | | | |
|---------------------|---------------|---------------|---------------|---------------|---------------|---------------|
| | 28TSC 22ga | 33TSC 20ga | 43TSC 18ga | 54TSC 16ga | 68TSC 14ga | 97TSC 12ga |
| Down | 1090 (4.85) | 1130 (5.03) | 1330 (5.92) | 1340 (5.96) | 1340 (5.96) | 1340 (5.96) |
| Up - Gravity & Wind | 550 (2.45) | 770 (3.43) | 990 (4.40) | 1200 (5.34) | 1200 (5.34) | 1200 (5.34) |

General Notes:

1. SDS = Self-Drilling Tapping Screw. Screws to be applied through the pre-drilled holes in hanger into the TrusSteel chord. The same quantity of screws is to be applied on the side of the hanger that is not visible.
2. Do not overdrive screws. Overdriven screws may strip out of TrusSteel chord.
3. Hangers may be located anywhere along girder chords.
4. Refer to TrusSteel detail drawings TS023 or TS024 for ply-to-ply connections for multi-ply girders.
5. Cold-Formed Steel calculations are per the 2020 supplement to AISI 2016 "North American Specification for the Design of Cold-Formed Steel Structural Members" (S100-16/S2-20).



www.TrusSteel.com

155 Harlem Ave., North Building, 4th Floor / Glenview, IL 60025 / (800) 755-6001

TSJH22, TSJH24 And TSJH44 Hanger Application

Alpine, a division of ITW Building Components Group, Inc. shall not be responsible for any performance failure in a connection due to a deviation from this detail. Any variation from this detail shall be approved in advance by Alpine, a division of ITW Building Components Group, Inc.

Standard Detail:
TS022

Date:
06/01/22

TrusSteel Detail Category:
Truss-To-Truss Connections